

**Collingwood Area School**  
**Civil Defence**  
**Welfare Centre Plan**

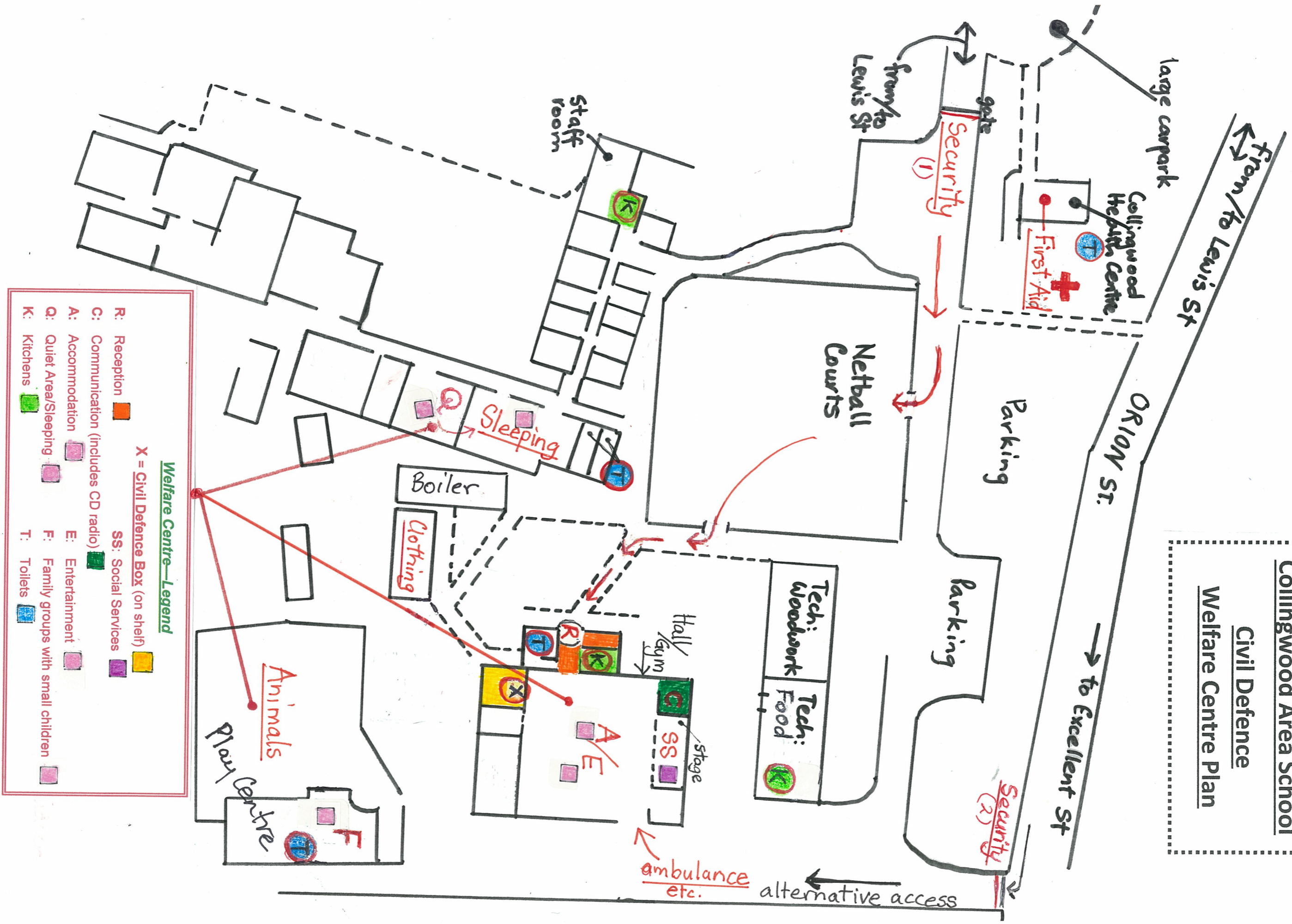

- Welfare Centre—Legend**
- R: Reception ■
  - C: Communication (includes CD radio) ■
  - A: Accommodation ■
  - Q: Quiet Area/Sleeping ■
  - K: Kitchens ■
  - X = Civil Defence Box (on shelf)
  - SS: Social Services ■
  - E: Entertainment ■
  - F: Family groups with small children ■
  - T: Toilets ■